



MAINTENANCE AND CARE INSTRUCTIONS

Olympia products are designed and engineered under strict quality standards. Regular and proper care of our products will ensure years of trouble free service. To clean, simply wipe with a damp, soft cloth. Do not use abrasive or harsh cleaners as they may result in finish damage. Regularly remove and clean minor debris from the aerator.

TO SET OR ADJUST TEMPERATURE LIMIT STOP

Caution: Valve is preset at the factory at maximum setting. Adjust as necessary. Please see instructions below:

1. Turn off water at the source and relieve pressure.
2. Remove handle (H) and loosening handle set screw, lift up the handle (H).
3. Unscrew retainer ring (G) and lock nut (F) by turning counter-clockwise.
4. Raise the red adjustment ring on the ceramic disc cartridge (E).
5. Turn adjustment ring counterclockwise to decrease temperature setting then replace the adjustment ring on the ceramic disc cartridge.
6. Reassemble and test until desired temperature is reached. (Note: Ensure a proper alignment of cartridge with notch in valve body.)

TROUBLE SHOOTING

A. If faucet has low flow:	1. Ensure water supplies are fully open.
	2. Remove aerator, clean all internal debris and tighten the aerator back.
	3. If low flow continues, remove and clean cartridge (E) by following procedures above.
B. If water leaks under the faucet:	1. Check SST flex hose and center outlet line connections and supply line hookups to ensure they are tightly fastened.
C. If water leaks below the handle:	1. Ensure assembly of cartridge (E), lock nut (F) and retainer ring (G) are securely tighten. Replace cartridge (E) if necessary.

OLYMPIA FAUCETS, INC. LIMITED LIFETIME WARRANTY *

Olympia Faucets, Inc. warrants its products to the original consumer purchaser to be free from defects in material and workmanship as long as the consumer purchaser owns it. Dated proof of purchase must accompany all warranty claims. PVD finishes carry a lifetime warranty in residential service.

Olympia Faucets, Inc. will replace, free of charge, to the original consumer purchaser, any and all parts that prove defective under normal installation, use, and service. Damage as a result of misuse, abuse, accident, or improper installation, will consequentially void this warranty. Replacement parts can be obtained from your local dealer or directly from Olympia Faucets. Olympia Faucets, Inc. recommends using a certified plumber for all faucet installation and repair.

This warranty is limited to replacement of defective parts only. Incidental and consequential damages, labor charges, repair, or replacement costs are expressly excluded. Some states do not allow the exclusion or limitation of incidental or consequential damages, so the above limitation may not apply to you. This warranty gives you specific legal rights, as you may have other rights of which vary from state to state.

Installation or maintenance and cleaning must be in compliance with instructions furnished with every Olympia product. If you find a problem with your product, please immediately contact your nearest Olympia Faucets, Inc. dealer or sales representative.

* 2 year limited warranty on commercial and multi-family projects.



INSTALLATION AND MAINTENANCE INSTRUCTIONS FOR OLYMPIA SINGLE HANDLE KITCHEN FAUCET

THIS PRODUCT MEETS THE FOLLOWING STANDARDS: ASME A112.18.1 ~ ANSI A117.1 ~ ANSI / NSF 61, SECTION 9 ~ UPC / IAPMO LISTED / ADA COMPLIANT ~ COMPLIES WITH CALIFORNIA LEAD PLUMBING LAW

PRODUCT NUMBERS

#K-5440 Lever Handle

#K-5441 Lever Handle-With Side Spray

ADA





Thank you for purchasing this quality product. Olympia products are rigorously tested to provide long service under normal conditions. Prior to installation, familiarize yourself with this parts diagram. Make sure that you have all of the illustrated parts for your Olympia product before installation.

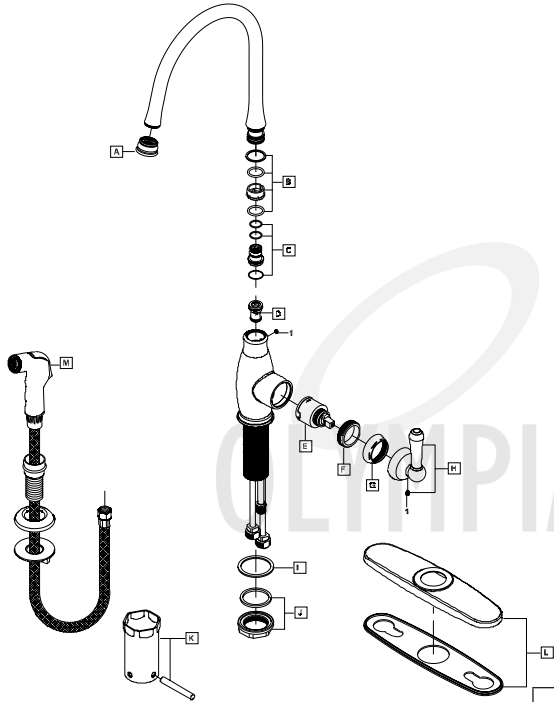

	ITEM #	DESCRIPTION
A	OP-420048*	1.5 GPM Aerator
B	OP-420041	Spout Swivel Repair Kit
C	OP-420049	Spout Repair Kit
D	OP-420024	Diverter Piston
E	OP-320002	Ceramic Disc Cartridge
F	OP-420042	Lock Nut
G	OP-420043*	Retainer Ring
H	OP-120002*	Lever Handle
I	OP-420044	Washer
J	OP-520005	Mounting Kit
K	OP-520008	Mounting Tool
L	OP-420045*	Deck Plate
M	OP-420038*	Side Spray Assembly
1	OP-420047	Allen Screw

* Note- Please Specify finish\color code while ordering.

INSTALLATION INSTRUCTIONS

Tools you will need:

- Plumbers Putty
- Screwdriver
- Pipe Wrench
- Basin Wrench
- Teflon Tape
- Flexible Supply Lines
- Adjustable Wrench
- Soft Cloth

FOR 3 OR 4 HOLE INSTALLATION:

- Carefully shut off both hot and cold water from underneath of the sink. Plug the sink drain with a soft cloth to prevent intrusion of debris or the loss of any faucet parts. If this installation is for a replacement, carefully remove the existing faucet and clean the entire surface of the sink mounting holes.
- Position the faucet on the top of deck plate (L), Place adequate amount of plumbers putty along the base gasket if necessary. Note:-Put base gasket under deck plate. Place deck plate with base gasket (L) on the mounting surface. Lead supply lines through the center hole.
- Attach lock nut (J) onto the faucet and tighten with the help of mounting tool (K) until the faucet is securely in place. Do not overtighten.
- Connect inlet lines to hot (LEFT INLET) and cold (RIGHT INLET) water supply lines. Connect water supply lines to water supply stops. Use with teflon tape for threaded connections.

SPRAY ASSEMBLY INSTALLATION:

- Apply adequate amount of plumbers putty under the hose guide flange. Place spray hose guide in far right hole of sink and then attach both the washer and locknut from underneath of the sink.
- Insert the compression nut end of spray hose down through the hose guide. To connect to the center faucet outlet, hand tightening securely. Note: Use teflon tape on this connection.
- Turn on the hot and cold water. Check all around for any leaks.
- Remove the aerator. Turn on the handle to let hot and cold water run for one minute to flush out any debris out of faucet body then replace the aerator back.

FOR 1 OR 2 HOLE INSTALLATION:

- Carefully shut off both hot and cold water from under the sink. Plug the sink drain with a soft cloth to prevent intrusion of debris or the loss of any faucet parts. If this installation is for a replacement, carefully remove the existing faucet and clean the entire surface of the sink mounting holes.
- Ensure the washer (I) is under the bottom of the faucet. Position the faucet, and from below, tighten the lock nut (J) with the help of mounting tool (K) to secure faucet to the mounting surface, Do not overtighten.
- Connect inlet lines to hot (LEFT INLET) and cold (RIGHT INLET) water supply lines. Connect water supply lines to water supply stops. Use with teflon tape for threaded connections.
- Turn on the hot and cold water. Check all around for any leaks.
- Remove the aerator. Turn on the handle to let hot and cold water run for one minute to flush out any debris out of faucet body then replace the aerator back.



For more care information or trouble shooting inquiries about your Olympia product, please call:
OLYMPIA FAUCETS, INC. (888) 772-7701
 Central Standard Time: 8:00am ~ 7:00pm
www.olympiafaucets.com